

FORK MOUNTED SCOOP

WHITNEY

SECATOL



Presentation: The Fork mounted scoop is the perfect and inexpensive accessory to use for re-handling operations. It can be handled by a forklift and operated from the cockpit. The scoop is reinforced to guarantee its longevity.

Use: Loading, transport, storage and handling of diverse materials such as sand, rubble, gravels, sawdust, cereals, dead leaves, rubbish, etc.

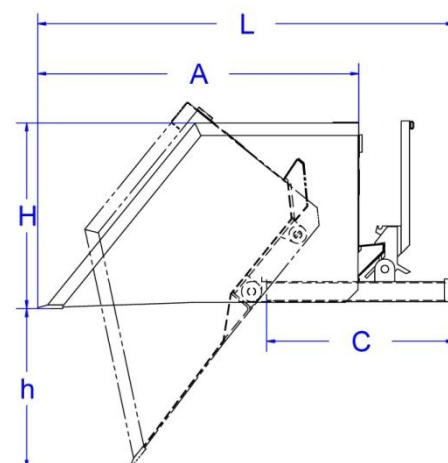
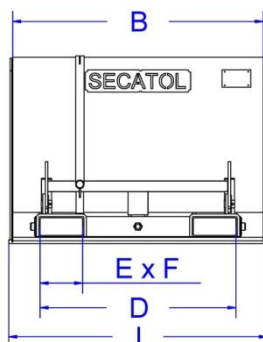

Ref.	Capacity (in Litres)	Product code	Dimensions (in mm)						Overall dimensions (mm)			Weight (in Kg)
			A	B	C	D	E x F	h	L	I	H	
PB 500	500	78050	1 240	1 000	750	760	160x62	700	1 660	1 032	745	186
PB 750	750	78075	1 240	1 250	750	760	160x62	700	1 660	1 282	745	200
PB 1000	1 000	78100	1 240	1 500	750	760	160x62	700	1 660	1 532	745	222

These technical details are given for information purposes only, they can be changed without any notice.

WHITNEY

Ladybird House, Brockhill Yard, Hewell Lane, Redditch, B97 6QT
www.whitneyeng.com sales@whitneyeng.com 01785 282811
 Sole UK dealers for SECATOL Equipment

PB