

# BAM 350 STEEL MORTAR TRAY

**WHITNEY**

**SECATOL**



**Use:** Reception, storage and distribution on site of mortar or other materials, with a maximum density of 2,4kg/l.

**Advantages of the 350 L MORTAR TRAY:**

- ✓ Stackable
- ✓ Easy to clean
- ✓ Light
- ✓ Robust
- ✓ Handling by crane or hydraulic crane
- ✓ Handling by forklift
- ✓ Can be directly filled by the mixer truck

On request, it is possible to manufacture a special mortar tray adapted to your constraints of use (capacity, shape, dimensions, thickness, etc.)

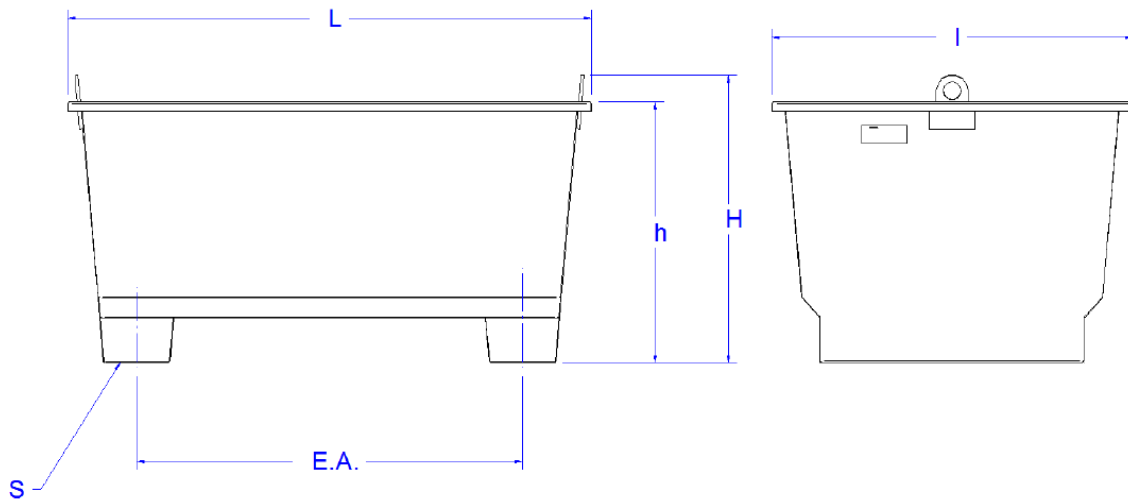

| Product code | Reference | Capacity (in Litres) | Dimensions (in mm) |     |        | Overall size (in mm) |     |     | Weight (in Kg) | CMU (kg) |
|--------------|-----------|----------------------|--------------------|-----|--------|----------------------|-----|-----|----------------|----------|
|              |           |                      | EA                 | h   | S      | L                    | I   | H   |                |          |
| 27035        | BAM 350L  | 350                  | 854                | 580 | 145x98 | 1 160                | 800 | 638 | 35             | 840      |

These technical details are given for information purposes only, they can be changed without any notice.

**WHITNEY**

Ladybird House, Brockhill Yard, Hewell Lane, Redditch, B97 6QT  
 www.whitneyeng.com sales@whitneyeng.com 01785 282811  
 Sole UK dealers for SECATOL Equipment

**BAM**